

**1'X1'**

**SURFACE APPLIED  
2.35" DOME SPACING**

www.AccessTile.com 888-679-4022

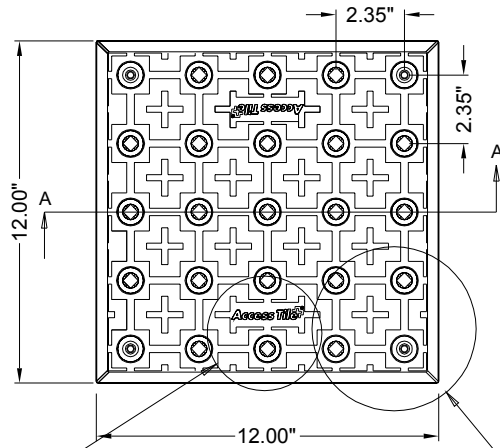

**PLAN**

SEE DETAIL A

SEE DETAIL B

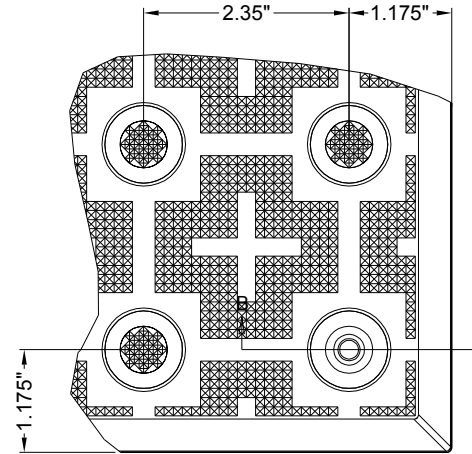

**DETAIL B**

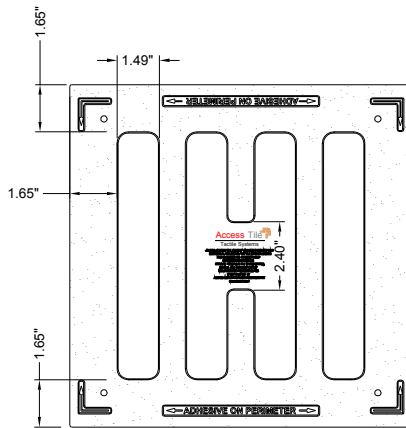

**UNDERSIDE VIEW**

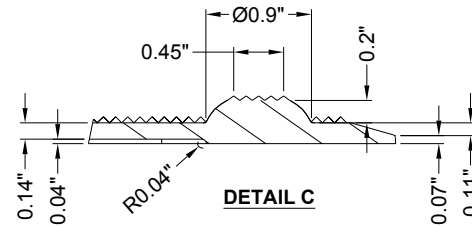

**DETAIL C**

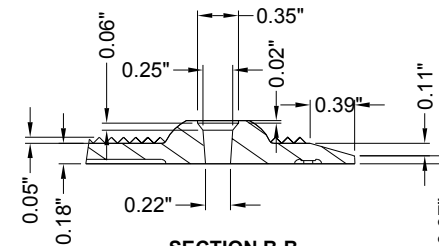

**SECTION B-B**

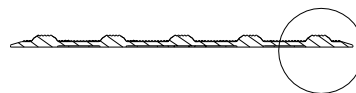

**SECTION A-A**

SEE DETAIL C



**DETAIL A**

www.AccessTile.com

Access Products Inc

© Access Products Inc.  
ACCESS, ACCESS TILE, ACCESS AND THE THREE AND TWO  
DIMENSIONAL DESIGNS ON THE TILE BETWEEN DOMES  
AND ON DOMES ARE TRADEMARKS OF  
ENGINEERED SYSTEMS INC.  
PATENTS PENDING IN THE UNITED STATES,  
CANADA AND INTERNATIONALLY  
MANUFACTURED AND DISTRIBUTED  
UNDER LICENSE BY  
ACCESS WORLD PRODUCTS INCORPORATED  
www.accesstile.com  
© KENNETH E.  
SZEKELY

**MATERIAL LIST**

| ITEM | DESCRIPTION           | PART NO.   | QTY  |
|------|-----------------------|------------|------|
| 1    | ACCESS TILE           | ACC-S-1X1  | 1    |
| 2    | Tek™ ANCHOR           | ACC-S-ANCH | 4    |
| 3    | TACTILE BOND AND SEAL | TBS-010    | 1 ea |

NOTE: FASTENERS ARE INCLUDED WITH TILE

**REFERENCE DRAWINGS**

| DWG. NO. | DESCRIPTION |
|----------|-------------|
|          |             |
|          |             |
|          |             |
|          |             |

| No. | DATE | REVISION | APPR. |
|-----|------|----------|-------|
|     |      |          |       |
|     |      |          |       |
|     |      |          |       |

SCALE 1"=1'-0" U.N.D. FULL SIZE ONLY

DESIGNED KES DATE 10/09/2008

DRAWN RWO DATE 10/15/2008

CHECKED KES

PROJECT MANAGER

TRADE DETECTABLE WARNING SURFACE PART NO. ACC-S-1X1

MATERIAL POLYMER COMPOSITE

SUBJECT **ACCESS TILE®**  
TRUNCATED DOME, DETECTABLE  
WARNING TACTILE SURFACE

PROJECT **ACCESS TILE®**  
TRUNCATED DOME, DETECTABLE  
WARNING TACTILE SURFACE  
1X1 SURFACE APPLIED  
INLINE DOME TILE DRAWING.

DRAWING NO. ACC-S-1X1 REV. NO. Ø